

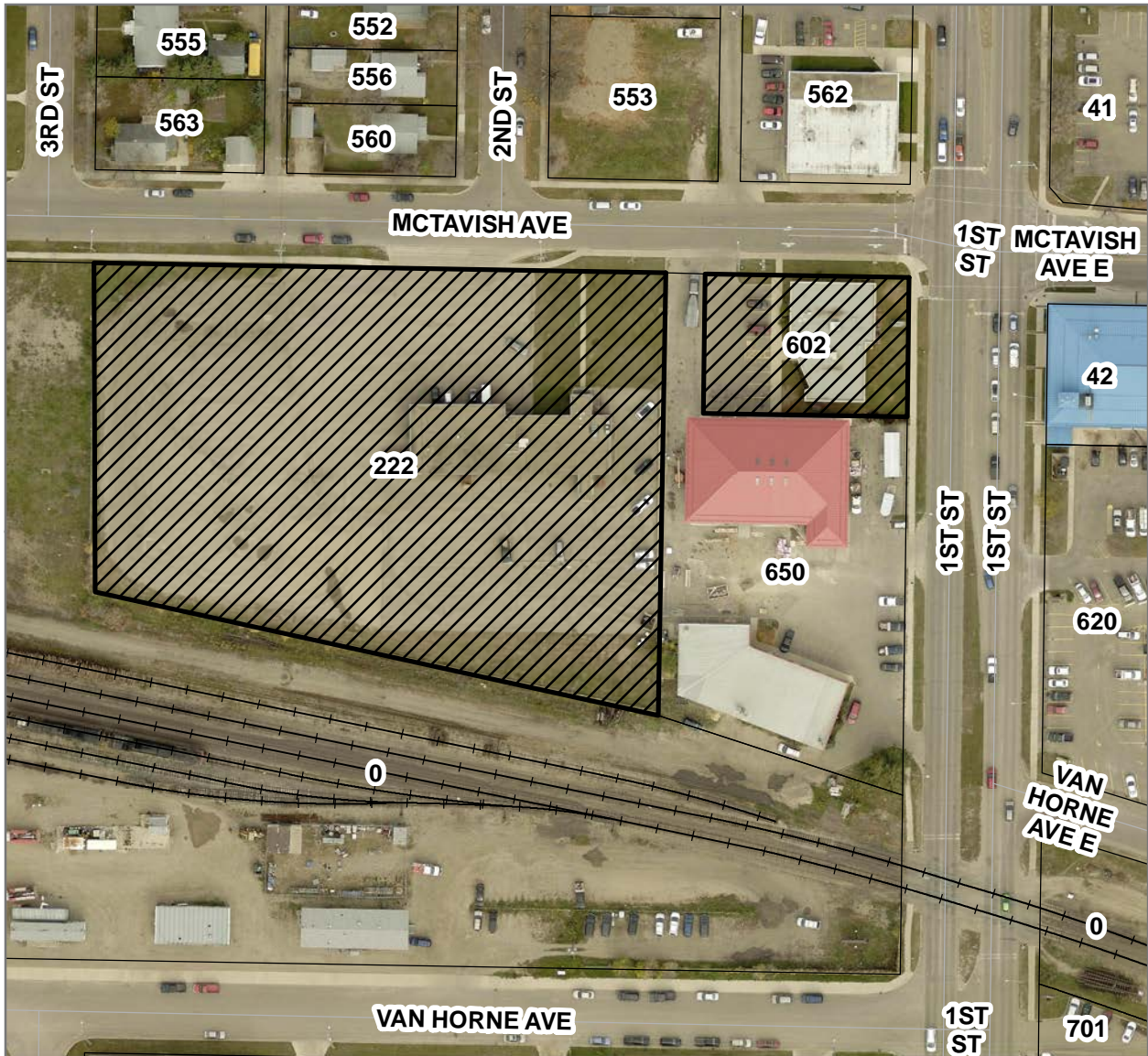

Variance Application

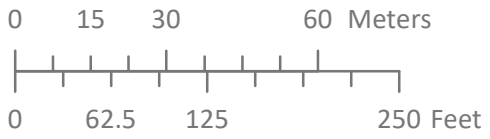

Variance Application V-19-17-B
 602 1st Street
 Parcel One: Lot 1, Plan 37565 BLTO,
 Parcel Two: Lots 13-15, Block 65 Plan 8 BLTO (602 1st Street)
 222 McTavish Avenue
 Lot 3 Plan 37565 BLTO



LEGEND
 Affected Lots







City of Brandon
 Planning, Property
 and Buildings Department



Map Created: 12/06/2017
 Revised:

KEY:

- ① BRIGHTSIDE DENTAL BUILDING & ADDITION (800sqm)
- ② ACCESS LANE TO ADJACENT PROPERTY
- ③ BRIGHTSIDE DENTAL PARKING (41 spaces)
- ④ WAREHOUSE BUILDING PARKING (15 spaces)
- ⑤ EXISTING ASPHALT SURFACE
- ⑥ ONE STOREY EXISTING BUILDING
- ⑦ TWO STOREY EXISTING BUILDING
- ⑧ ONE STOREY EXISTING BUILDING

-  LANDSCAPED AREA
-  EXIST. PARKING AREA
-  EXIST. GRAVEL
-  TREE
-  EXIST. HYDRO POLE
-  EXIST. LIGHT POLE
-  TRAFFIC FLOW DIRECTION

LEGAL DESCRIPTION

35385 D, LOT 3, OF PLAN 37565, BRANDON LAND TITLE OFFICE
 LOT 1, OF PLAN 37565, BRANDON LAND TITLE OFFICE
 LOTS 13, 14 AND 15 IN BLOCK 65 OF PLAN 8, BRANDON LAND TITLE OFFICE

McTavish Avenue

First Street

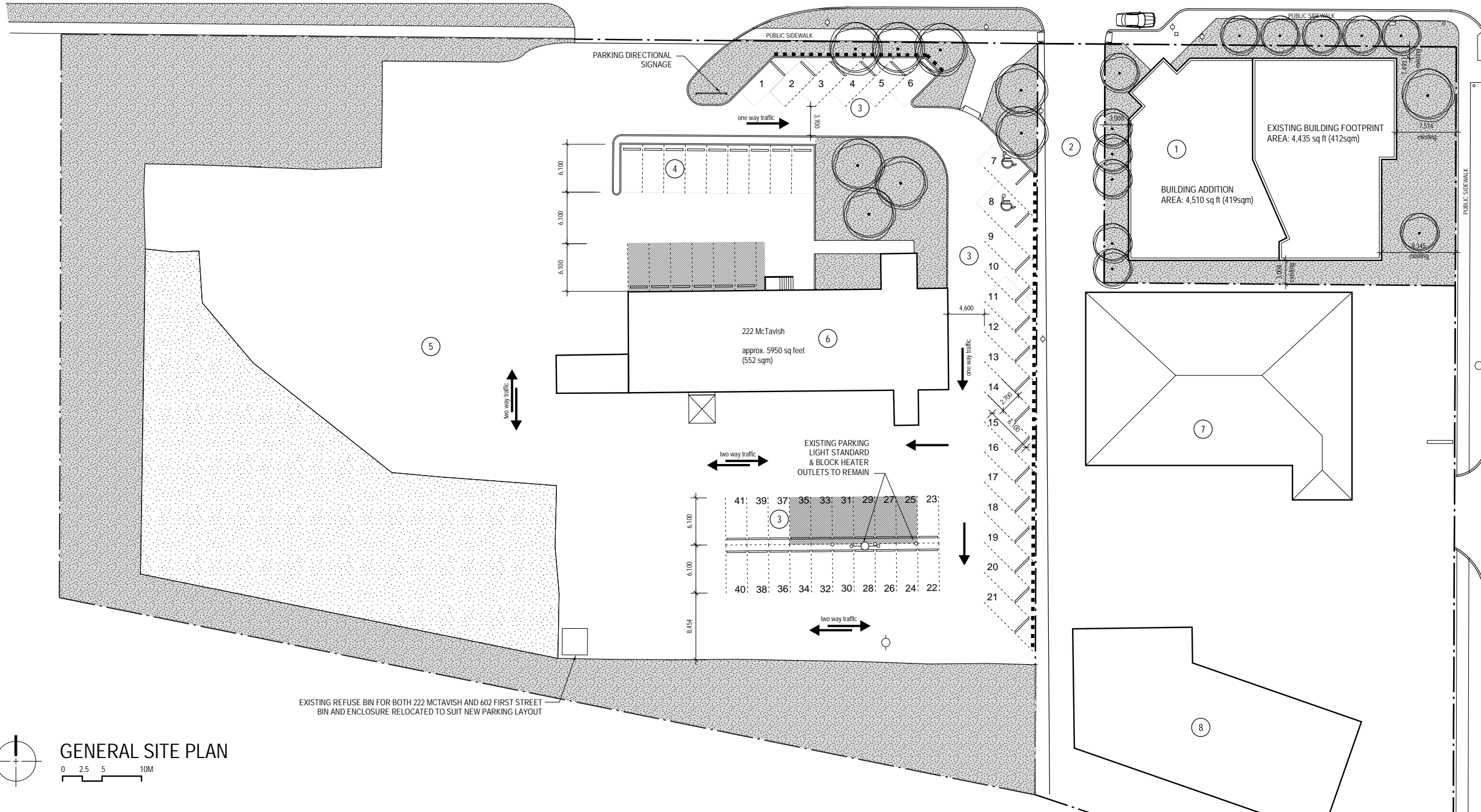

EXISTING REFUSE BIN FOR BOTH 222 MCTAVISH AND 602 FIRST STREET
 BIN AND ENCLOSURE RELOCATED TO SUIT NEW PARKING LAYOUT

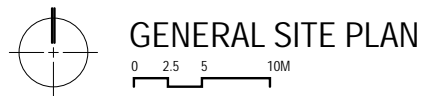

GENERAL SITE PLAN